



ABRASIVE FLOW SOLUTIONS



METAL SEATED SWING CHECK VALVE

Our Metal Seated Swing Check Valve is designed for the water industry, taking into account the latest developments and know-how, exceeding the requirements of BS 5163 (EN 12334) and DIN 3202 F6. Swing Check Valve allows full, unobstructed flow and automatically starts to close as velocity decreases. The valve is fully closed when the flow reaches to zero and it prevents back flow. Pressure drop across the valve is very low.

Product Specifications:

Size Range:	DN50 - DN2000
Valve Type:	Swing Check Valve
Materials:	A wide selection of materials is available; also internal hard rubber lining for saline applications.
Temperature Range:	-20°C to +70°C
Pressure Rating:	145 - 580psi (10 - 40 Bar)
Coating:	Fusion Bonded Epoxy (FBE)
Colour:	Blue, ca. RAL 5005

Features:

- Low head-loss.
- Drop-tight sealing due to Bronze/Gunmetal seats (standard).
- O-ring shaft seals as standard.
- Aeration and drain tap.
- Integrated lifting lug and holes.
- Easy replaceable o-ring shaft seals.

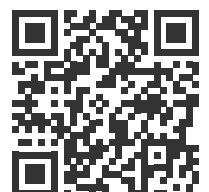

Applications

The valve is suited for pumping stations, treatment plants, reservoirs, pipelines, power stations, desalination plants & industrial applications.

Dimensions & Weights

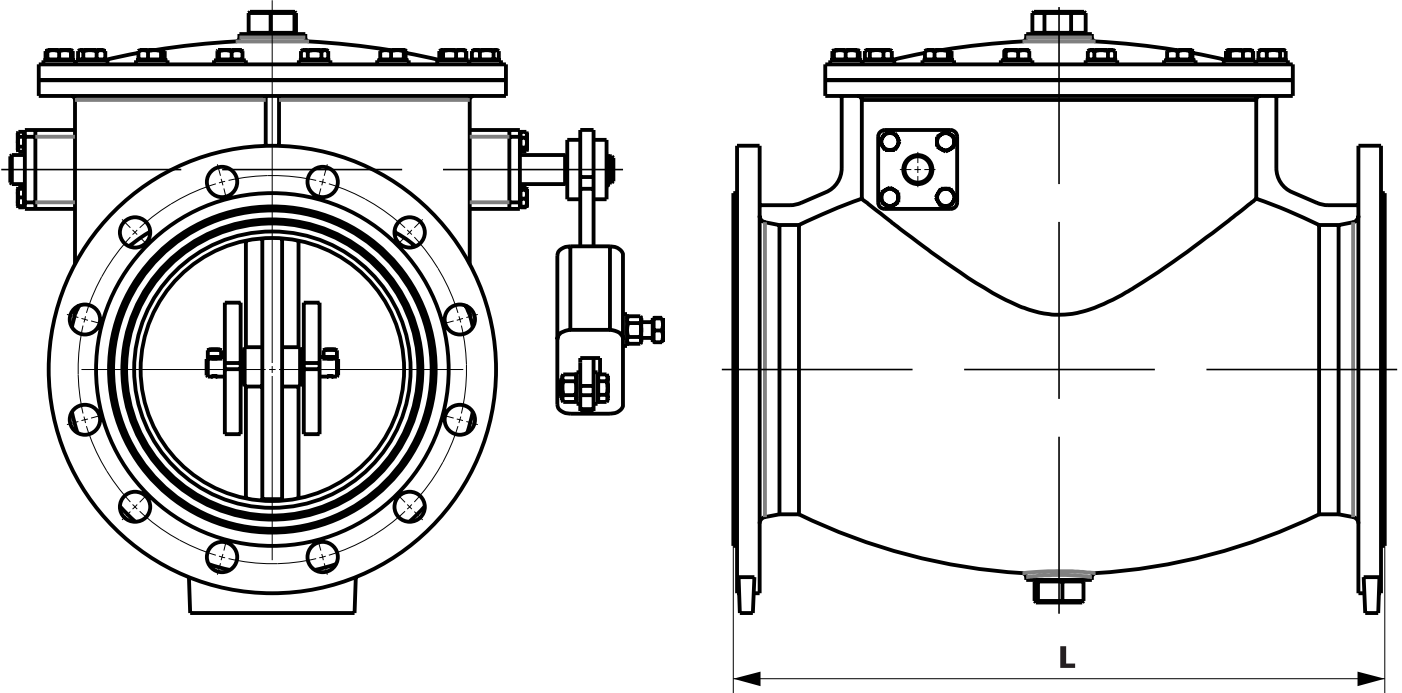

DN	BS 5153 (L)	DIN 3202 F6 (L)
80	241	260
100	292	300
125	356	400
150	495	500
200	622	600
250	698	700
300	788	800
350	915	900
400	965	1000
450	1067	1100
500	1219	1300
600	1420	1500
700	1560	1700
800	1730	1900
900	1880	2100
1000	2032	2300
1200	2185	2500

Dimensions and weights are for guidance only - detailed dimension drawings available on request. All dimensions are in millimeters, unless stated otherwise.

